



Project

PROJ-037-2021

Surface: 140 m²

Email: info@benito.com

Telephone: +34 93 852 1000

BENITO
-Playground Equipment

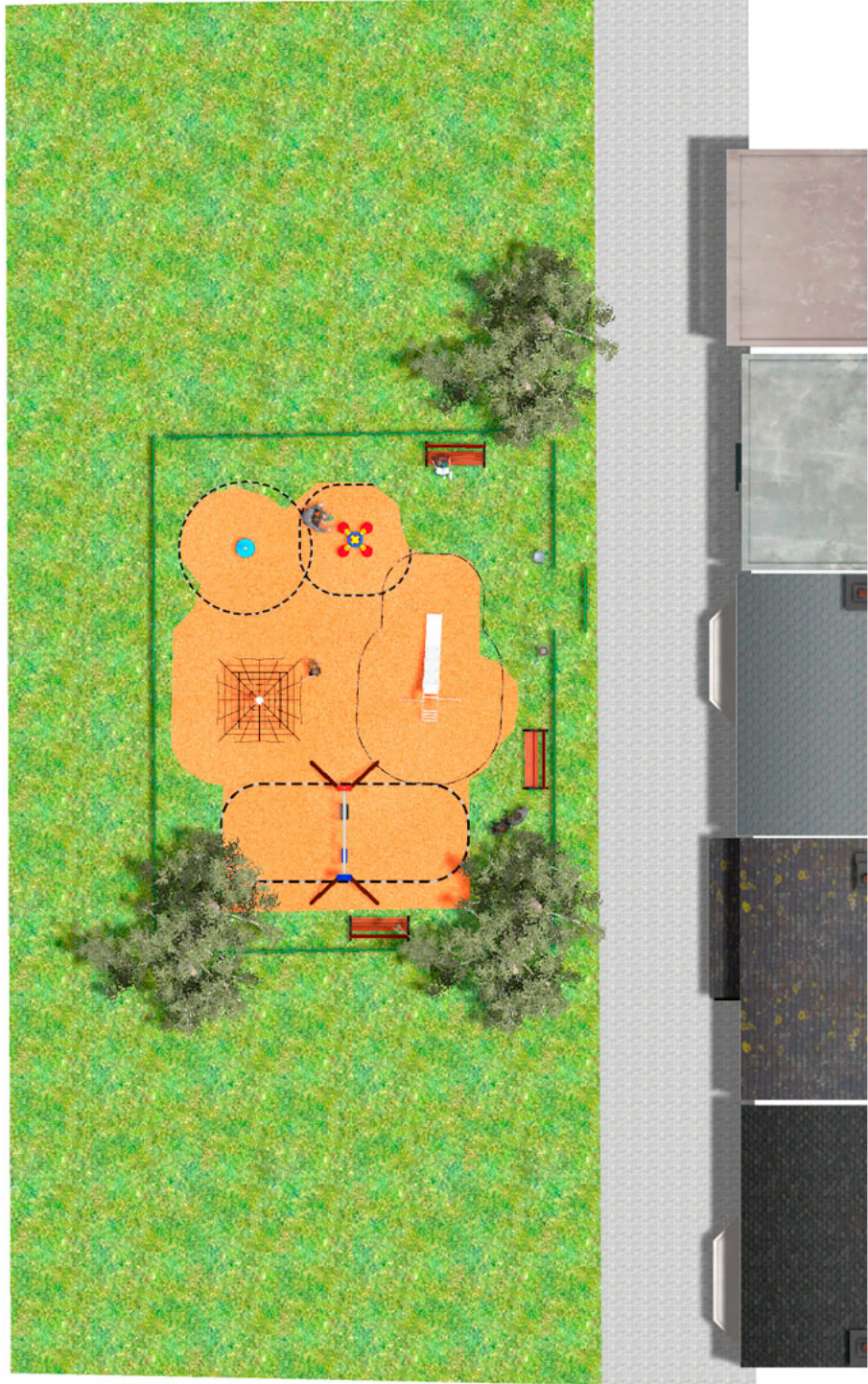





BENITO
-Playground Equipment



BENITO

-Playground Equipment



Product	Description
JL1511000 	<p>MADERA 1 Flat 1 Cradle Swings for children made of different materials such as wood and steel. Resistant to abrasion, corrosion and bad weather conditions.</p> <p>Data Sheet JL1511000 Certificate Certificate Conformity</p>
JFS06 	<p>Flop Fun and educative spring swing for children. Made of resistant materials according to the EN1176 standard.</p> <p>Data Sheet Certificate Certificate Conformity</p>
JT03 	<p>Everest Panels, HDPE: high-density polyethylene characterised by its resistance to chemical abrasives. As a polymer, it is unaffected by corrosion. Due to its light elastic nature, it offers high resistance to impact, making it very difficult to break..</p> <p>Data Sheet Certificate Certificate Conformity</p>
JPV25 	<p>Metric 2,5 Structure, Metal: hot-dip galvanised steel poles are the centre of the fundamental structure of 3D nets. Their main function is to stabilise the rocking of the product and support heavy loads from several axis.</p> <p>Data Sheet Certificate Conformity Acreditative Letter</p>
JC03 	<p>Rotating Post Structure, Metal: hot dip galvanised and powder-coated rotating shaft.</p> <p>Data Sheet Certificate Conformity</p>