



PROJECT

PROJ-074-2018

Surface: 430 m²

Email: info@benito.com

Telephone: +34 93 852 1000

BENITO

—Playground Equipment

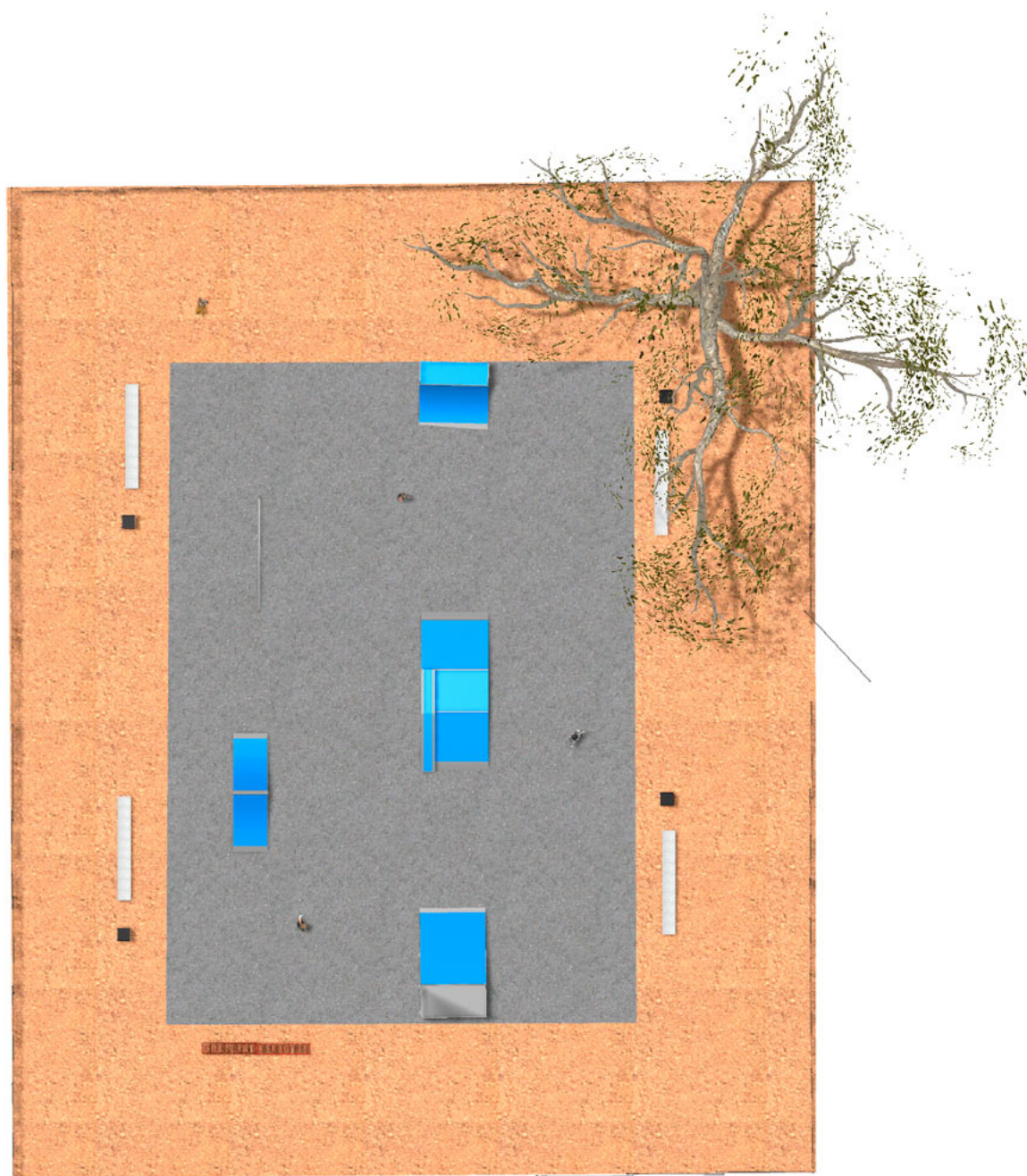

BENITO



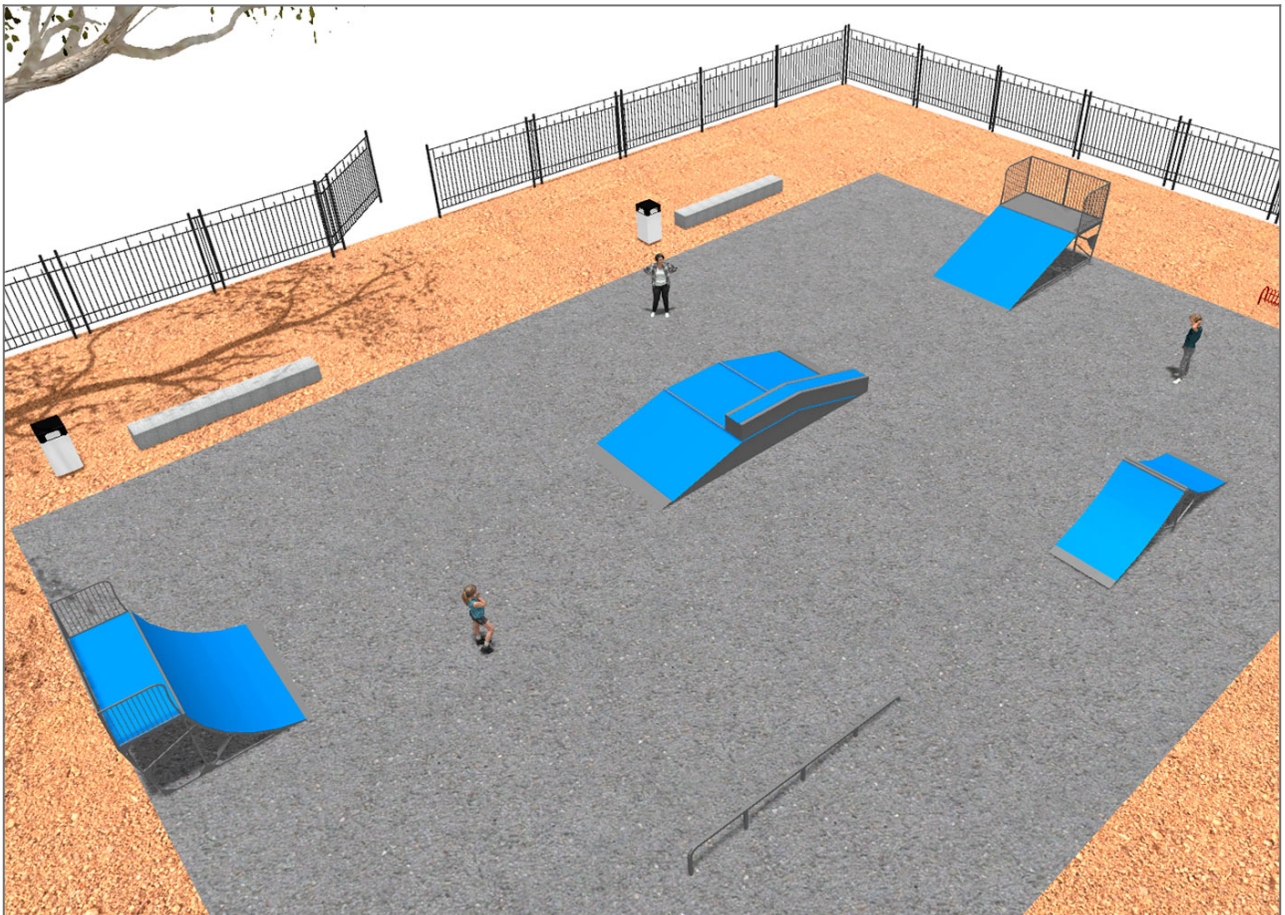

—Playground Equipment

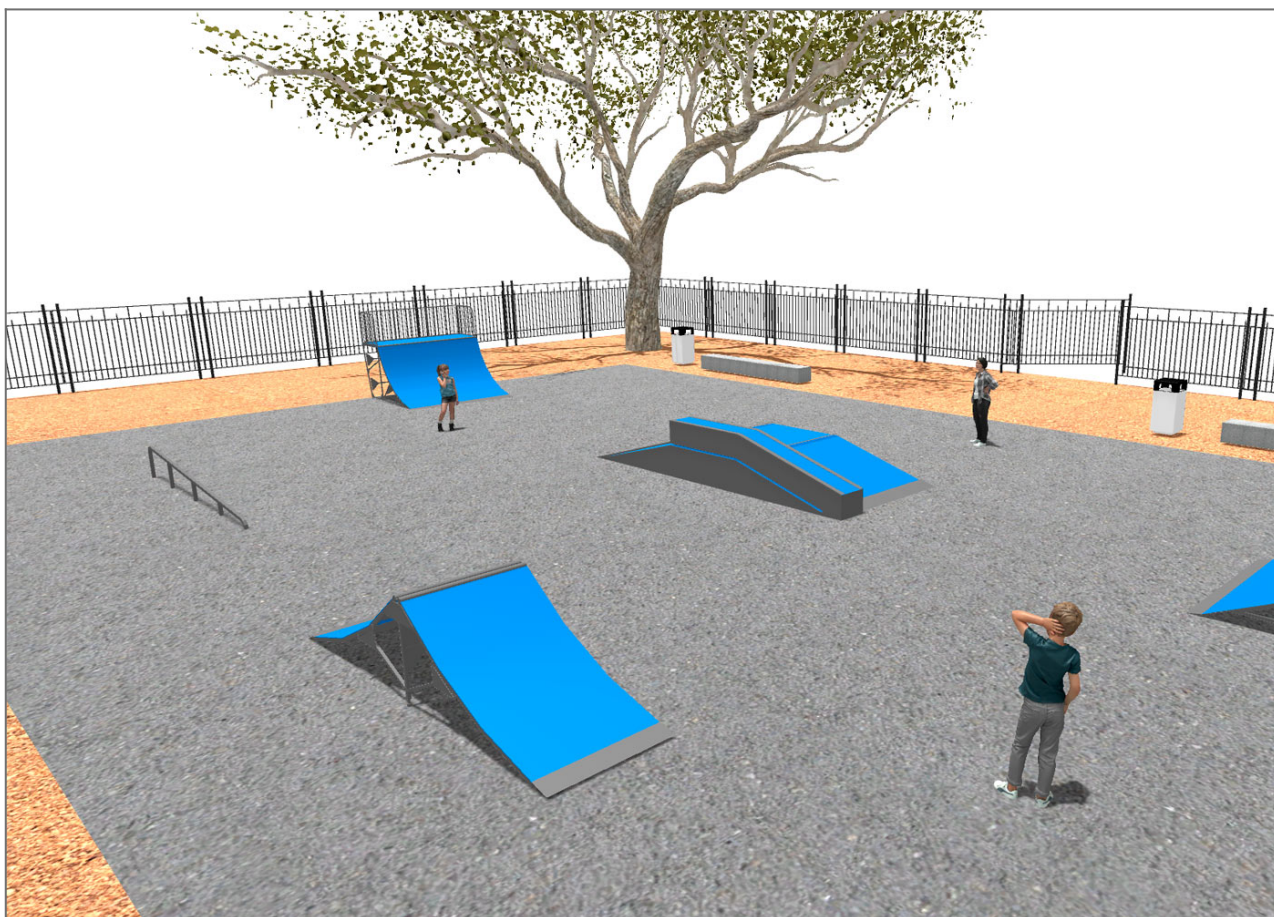
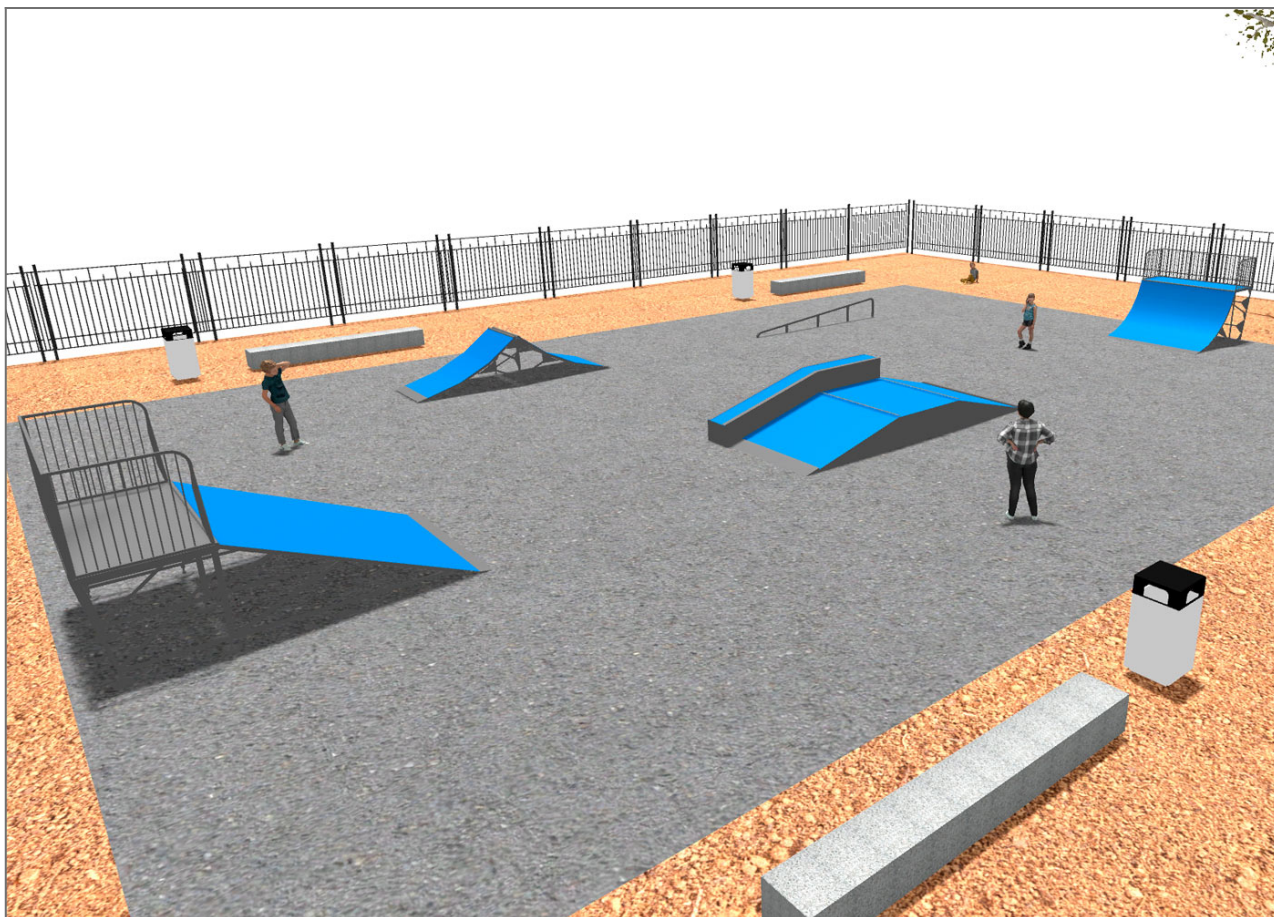

BENITO

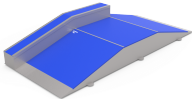
—Playground Equipment

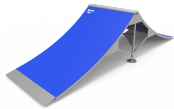

Product	Description
JSK9025-KBS 	One side Curb Box 60 The Skates elements are of modular construction that allows with the minimum effort the ability to modify the situation of the modules according to the criteria of each group of skaters. with minimum maintenance and 100% resistant to UVA rays, ice and impacts. Great adherence to the ground. The surface is not heated. Based on modular construction. Data Sheet
JSK1006-K 	Bank 125 The Skates elements are of modular construction that allows with the minimum effort the ability to modify the situation of the modules according to the criteria of each group of skaters. with minimum maintenance and 100% resistant to UVA rays, ice and impacts. Great adherence to the ground. The surface is not heated. Based on modular construction. Data Sheet
JSK1008-K 	Quarter Pipe 140 The Skates elements are of modular construction that allows with the minimum effort the ability to modify the situation of the modules according to the criteria of each group of skaters. with minimum maintenance and 100% resistant to UVA rays, ice and impacts. Great adherence to the ground. The surface is not heated. Based on modular construction. Data Sheet
JSK1048-C 	Rail C The Skates elements are of modular construction that allows with the minimum effort the ability to modify the situation of the modules according to the criteria of each group of skaters. with minimum maintenance and 100% resistant to UVA rays, ice and impacts. Great adherence to the ground. The surface is not heated. Based on modular construction. Data Sheet
JSK1013-K 	Spine 99 Data Sheet