



## PROJECT

PROJ-082-2018

Surface: 1130 m<sup>2</sup>

Email: [info@benito.com](mailto:info@benito.com)

Telephone: +34 93 852 1000

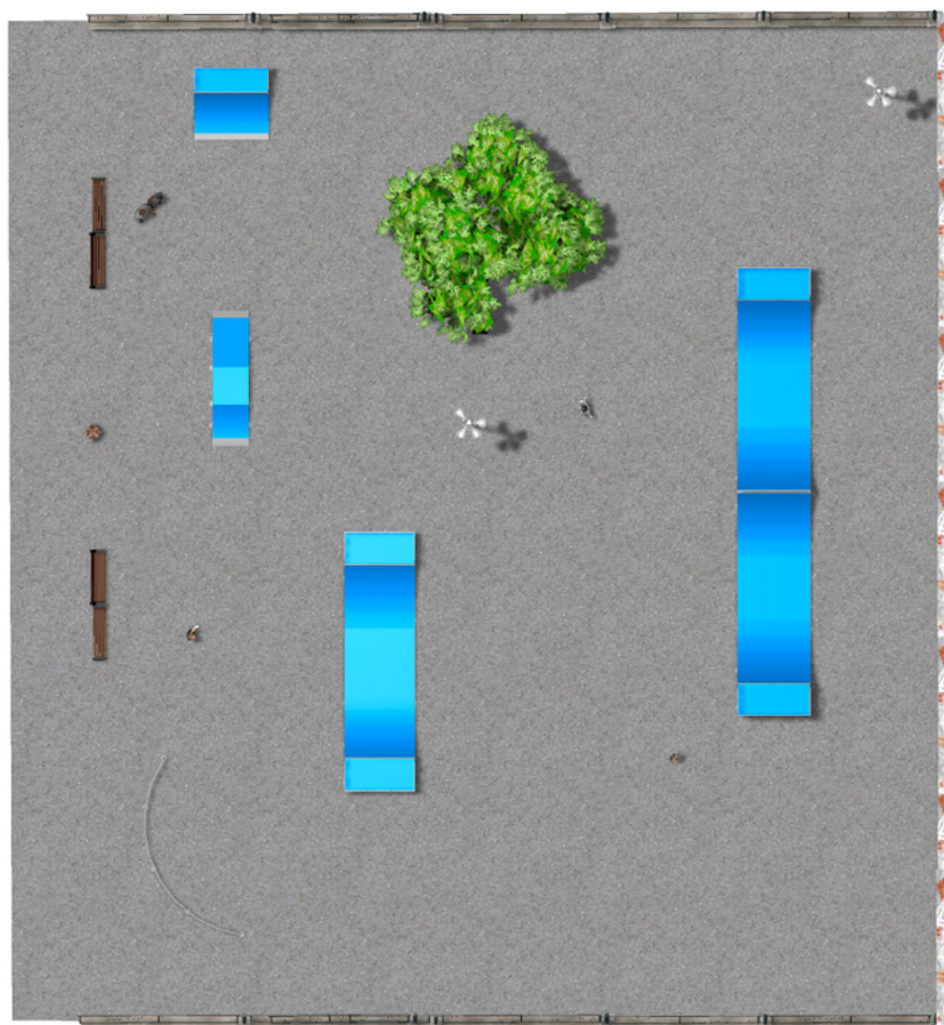





**BENITO**  
-Playground Equipment

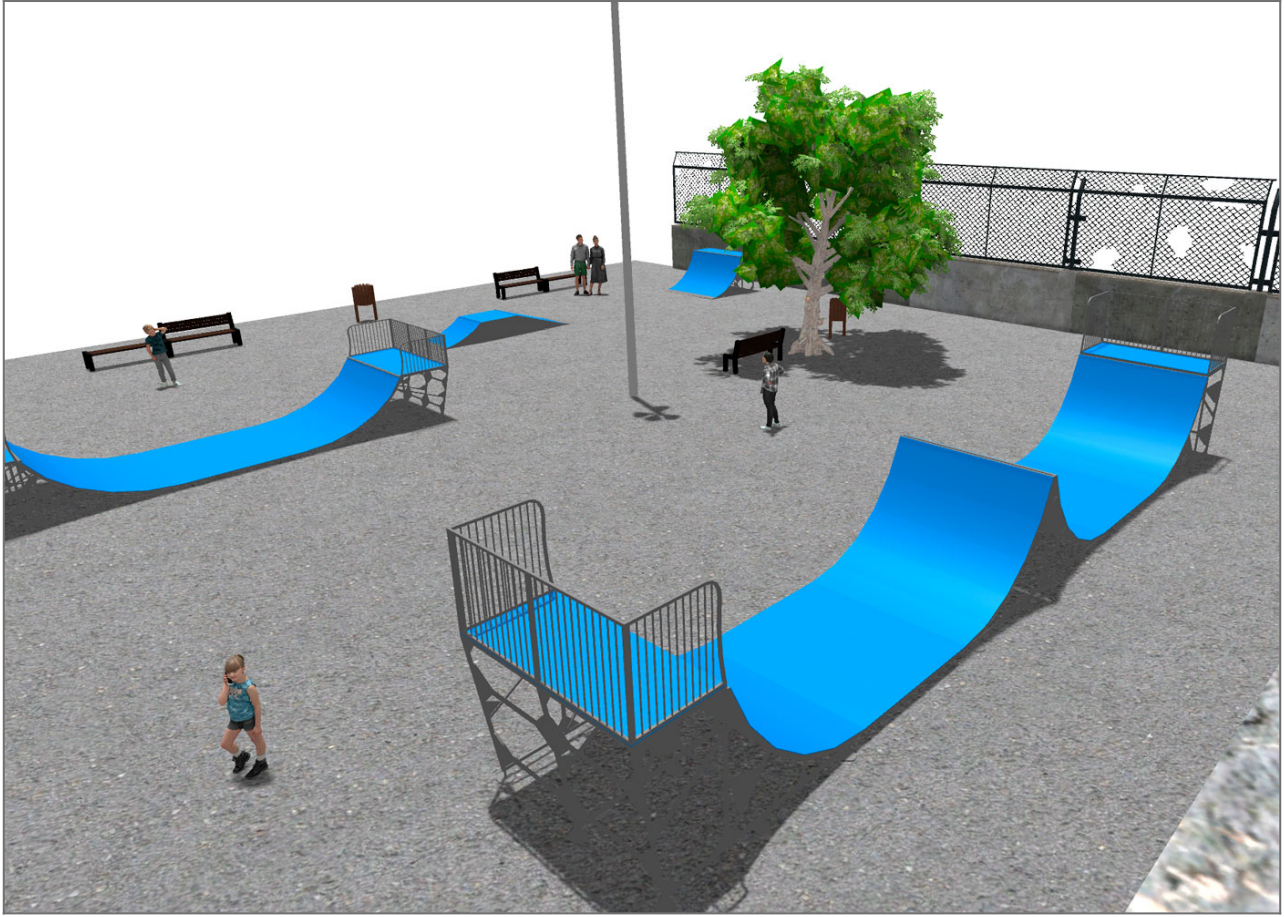

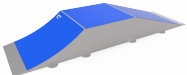
**BENITO**  
-Playground Equipment

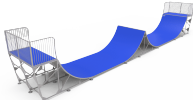

Product	Description
JSK1023-K 	<b>Launch Box 60 A</b> The Skates elements are of modular construction that allows with the minimum effort the ability to modify the situation of the modules according to the criteria of each group of skaters. with minimum maintenance and 100% resistant to UVA rays, ice and impacts. Great adherence to the ground. The surface is not heated. Based on modular construction. <a href="#">Data Sheet</a>
JSK1008-K 	<b>Quarter Pipe 140</b> The Skates elements are of modular construction that allows with the minimum effort the ability to modify the situation of the modules according to the criteria of each group of skaters. with minimum maintenance and 100% resistant to UVA rays, ice and impacts. Great adherence to the ground. The surface is not heated. Based on modular construction. <a href="#">Data Sheet</a>
JSK2015-K 	<b>Mini Ramp 140</b> The Skates elements are of modular construction that allows with the minimum effort the ability to modify the situation of the modules according to the criteria of each group of skaters. with minimum maintenance and 100% resistant to UVA rays, ice and impacts. Great adherence to the ground. The surface is not heated. Based on modular construction. <a href="#">Data Sheet</a>
JSK3015-K 	<b>Spine Ramp 125</b> The Skates elements are of modular construction that allows with the minimum effort the ability to modify the situation of the modules according to the criteria of each group of skaters. with minimum maintenance and 100% resistant to UVA rays, ice and impacts. Great adherence to the ground. The surface is not heated. Based on modular construction. <a href="#">Data Sheet</a>
JSK1049 	<b>Banana Rail</b> The Skates elements are of modular construction that allows with the minimum effort the ability to modify the situation of the modules according to the criteria of each group of skaters. with minimum maintenance and 100% resistant to UVA rays, ice and impacts. Great adherence to the ground. The surface is not heated. Based on modular construction. <a href="#">Data Sheet</a>