

# BENITO

-Playground Equipment



## Project

PROJ-004-2020

Surface: 125 m<sup>2</sup>

Email: [info@benito.com](mailto:info@benito.com)

Telephone: +34 93 852 1000

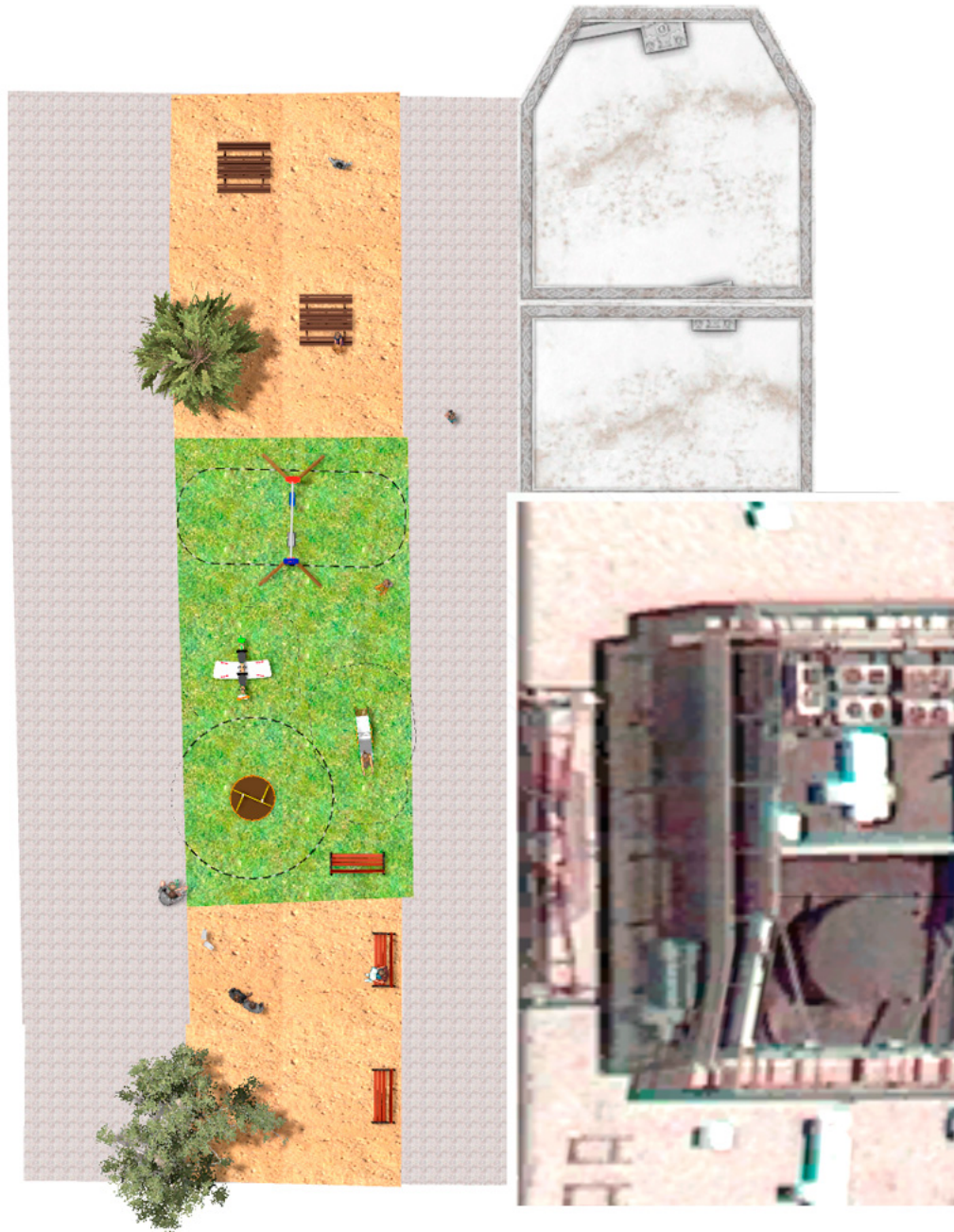

**BENITO**  
-Playground Equipment



**BENITO**  
-Playground Equipment



Product	Description
<p>JL1511000</p> 	<p><b>MADERA 1 Flat 1 Cradle</b> Swings for children made of different materials such as wood and steel. Resistant to abrasion, corrosion and bad weather conditions.</p> <p><a href="#">Data Sheet JL1511000</a> <a href="#">Certificate</a> <a href="#">Certificate Conformity</a></p>
<p>JT02</p> 	<p><b>Camel</b> <b>Panels, HDPE:</b> high-density polyethylene characterised by its resistance to chemical abrasives. As a polymer, it is unaffected by corrosion. Due to its light elastic nature, it offers high resistance to impact, making it very difficult to break.</p> <p><a href="#">Data Sheet</a> <a href="#">Certificate</a> <a href="#">Certificate Conformity</a></p>
<p>JFS11</p> 	<p><b>Sky</b> The thrill of flying a tandem airplane with friends hanging from the wings. Fun Springs for kids that enhance their learning. Made with durable materials and certified according to EN1176.</p> <p><a href="#">Data Sheet</a> <a href="#">Certificate</a> <a href="#">Certificate Conformity</a></p>
<p>JC05</p> 	<p><b>Sputnik</b> <b>Structure, Metal:</b> galvanised and powder-coated rotating shaft. Colours: JC05 - RAL6018, RAL1028 / JC05B - RAL2008, RAL1028.</p> <p><a href="#">Data Sheet</a> <a href="#">Certificate</a> <a href="#">Certificate Conformity</a></p>