

# BENITO

-Playground Equipment



## Project

PROJ-058-2022

Surface: 185 m<sup>2</sup>

Email: [info@benito.com](mailto:info@benito.com)

Telephone: +34 93 852 1000

**BENITO**  
-Playground Equipment

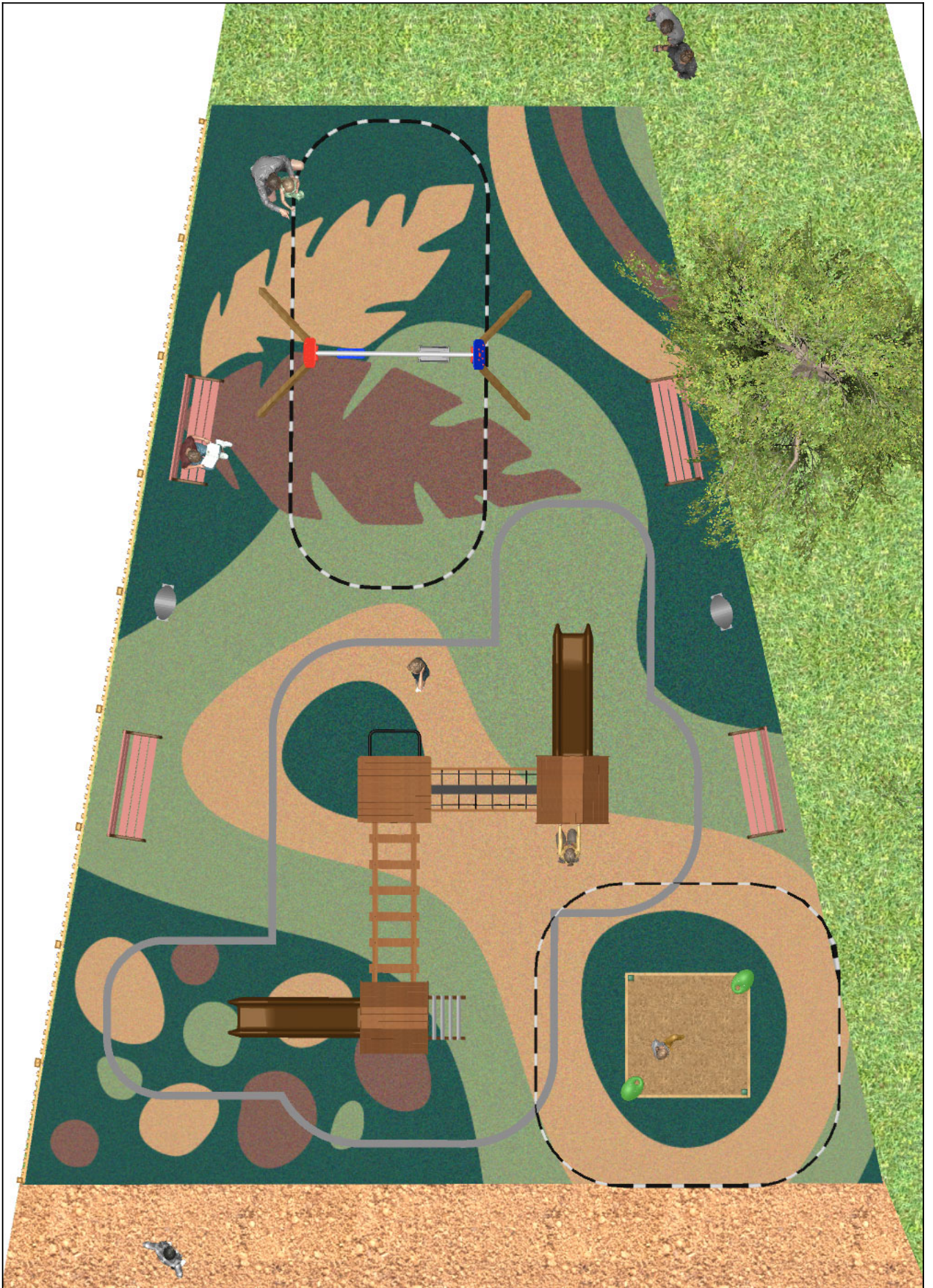

**BENITO**  
-Playground Equipment



**BENITO**  
-Playground Equipment



**BENITO**  
-Playground Equipment



Product	Description
<p>JAM15</p> 	<p><b>Kami 2x2</b>  <b>Structure, Laminated wood:</b> scandinavian laminated pine wood treated in autoclave Class IV. Finished with two layers of Lasur paint. In case of being subjected to bad weather conditions, laminated pine wood can present some tiny cracks on the surface that do not reduce its durability at all. As regards resin and knots, please note that these are part of its natural appearance.</p> <p><a href="#">Data Sheet</a> <a href="#">Certificate</a></p>
<p>JL1511000</p> 	<p><b>MADERA 1 Flat 1 Cradle</b>  Swings for children made of different materials such as wood and steel. Resistant to abrasion, corrosion and bad weather conditions.</p> <p><a href="#">Data Sheet JL1511000</a> <a href="#">Certificate</a> <a href="#">Certificate Conformity</a></p>
<p>JLET03</p> 	<p><b>Leto 3</b>  <b>LETO</b> collection made of sustainable materials: FSC wood, rice husk slides and ECOPlay panels. These structures are integrated into all types of environments, from the most rural to the most urban one.</p> <p><a href="#">Data Sheet JLET03</a> <a href="#">Certificate</a></p>
<p>PA694GE</p> 	<p><b>Dara Plus</b>  DARA PLUS designer Litter Bin , total dimensions (width x depth x height) 660x430x1270 mm, 200 liters, made of steel (treated with the Ferrus process, the triple-layer protector for iron, which guarantees optimal corrosion resistance). Finished with epoxy primer and black forged polyester powder paint. Body with built-in lid and ashtray. Prepared for anchoring with 4 M8 expansion bolts according to surface and project. Optional not included: Customizable marking with 74x35 mm/80x100 mm aluminum plate.</p> <p><a href="#">Data Sheet PA694GE</a></p>
<p>UM301</p> 	<p><b>Citizen</b>  Exclusive CITIZEN design Bench , total dimensions (length x height x depth) 1800x820x650 mm, manufactured with ductile iron legs (treated with the Ferrus process, the triple-layer protector for iron, which guarantees optimal corrosion resistance). Epoxy primer finish and Marson-colored polyester powder paint. Five tropical wood planks (treated with a triple-layer Lignus coating, a fungicidal, insecticidal and water-repellent protector) in a natural finish. Stainless steel hardware. Recommended anchoring: four M10 expansion bolts depending on the surface and project.  Optional items not included:  Customizable marking with 74x35 mm aluminum plate or milled board.</p> <p><a href="#">Data Sheet UM301</a> <a href="#">Data Sheet</a> <a href="#">Certificate TMA/851/2021</a></p>
<p>VRV470R</p> 	<p><b>Rústica Plana</b>  Rustic Flat Fence slat set, total dimensions 1950x700 mm, made of pine wood (treated in a class 4 vacuum-pressure autoclave to combat woodworm, termites, and insects). Prepared for anchoring in a concrete block (not included).</p> <p><a href="#">Data Sheet VRV470R</a></p>