

BENITO

-Playground Equipment

BENITO

- Urban
- Light
- Play
- Covers

Vista en perspectiva



Project

PROJ-053-2023

Surface: 150 m²

Email: info@benito.com

Telephone: +34 93 852 1000

BENITO
-Playground Equipment

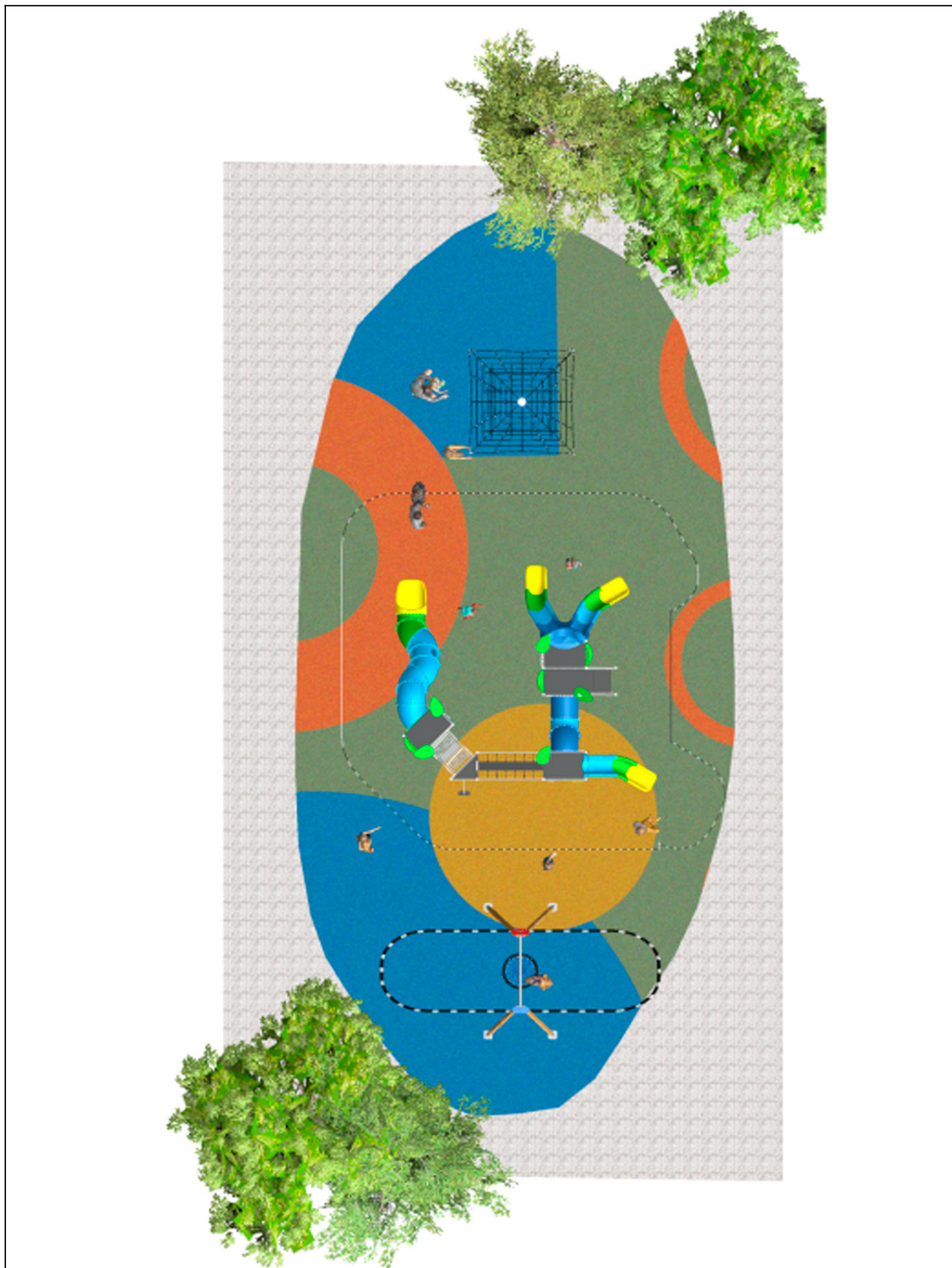

BENITO
-Playground Equipment



BENITO
-Playground Equipment

- BENITO**
- Urban
- Light
- Play
- Covers

Vista en perspectiva





BENITO
-Playground Equipment

BENITO
-Urban
-Light
-Play
-Covers

Vista en perspectiva



| Product | Description |
|--|---|
| <p data-bbox="172 159 264 185">JALU06</p>  | <p data-bbox="363 159 432 185">Alu 6</p> <p data-bbox="363 188 1505 275">The ALU collection maximises playability. Including lots of slides, bridges and dynamic elements, the ALU line encourages children to play, even those with disabilities. Its bright colours don't go unnoticed and the quality of materials guarantee high durability.</p> <p data-bbox="363 304 1062 331"> Data Sheet JALU06 Acreditative Letter Certificate Conformity </p> |
| <p data-bbox="159 427 280 454">JL1500010</p>  | <p data-bbox="363 427 555 454">MADERA 1 Nest</p> <p data-bbox="363 456 1477 515">Swings for children made of different materials such as wood and steel. Resistant to abrasion, corrosion and bad weather conditions.</p> <p data-bbox="363 544 884 571"> Data Sheet Certificate Certificate Conformity </p> |
| <p data-bbox="164 696 276 723">JPVRM25</p>  | <p data-bbox="363 696 480 723">Metric 2,5</p> <p data-bbox="363 725 1469 784">Structure, Metal: hot-dip galvanised steel poles are the centre of the fundamental structure of 3D nets. Their main function is to stabilise the rocking of the product and support heavy loads from several axis.</p> <p data-bbox="363 813 970 840"> Data Sheet Certificate Conformity Acreditative Letter </p> |