

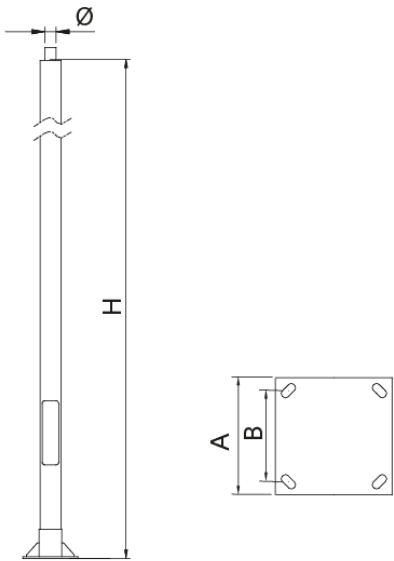

Pole manufactured in S-235 JR hot-dip galvanised steel. Height between 4 and 8m for TOP Ø60 mounting or Ø100 for ESSENTIALS bracket. Textured black RAL 9005 colour finish.



POLE:



Ref.	H	A	B
ICCL40ES1	4000	300	200
ICCL50ES1	5000	300	200
ICCL60ES1	6000	300	200
ICCL70ES1	7000	400	300
ICCL80ES1	8000	400	300

[Catalogue](#) | [HD image](#)

ILDL

Luminaire

DECO LIRA

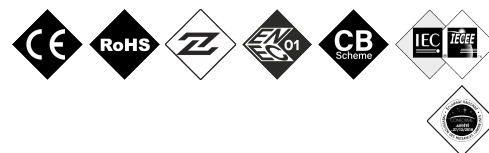
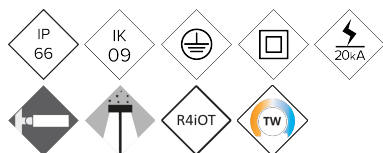

Belongs to the Essentials range, a set of luminaires of different types and styles that share a common aesthetic. Elegant and contemporary design ideal for all kind of applications, especially road and residential ones. Can be installed on 4m to 8 m poles. Optical design optimised for a perfect glare control and cut-off suitable for pedestrians without emission to the upper hemisphere.

MAIN FEATURES:

- High efficiency. Up to 142 lm/W net
- Essentials range. From 20W to 120W
- Finless passive dissipation
- Tool-less opening
- 18 light distribution curves
- Zhaga Standard (Book 15)
- Ready 4IoT. Ready for any intelligent lighting control solution

APPLICATIONS:

- Historical Centres
- Residential Streets (Zones 30)
- Pedestrian Zones
- Commercial and Tourist Streets
- Squares
- Green Areas; Parks and Gardens

[Project sheet](#) | [CAD](#) | [Catalogue](#) | [Mounting instructions](#) | [BIM](#) | [HD image](#)

BENITO

info@benito.com
tel. 93 852 1000

SPECIFICATIONS :

Housing material:	High pressure die-cast aluminium EN AC-43000, EN AC-43100, EN AC-43400, EN AC-44100, EN AC-47100 according to the UNE EN 1706 standard
Diffuser (optic system enclosure):	5mm tempered safety glass. UV filter
Fixing elements:	Stainless steel 18/8 - AISI 304
Housing:	Double compartment: driver / LED module
Sealing gaskets:	Silicone foam
IP rating (luminaire):	IP66
IP rating (optic system):	IP66
IK rating (impact resistance):	IK09
LEDs thermal dissipation:	Thermal dissipation through finless luminaire body, without conductive fluids. Passive convection dissipation ensuring thermal contact with the LED modules through a high-conductivity thermal transfer material
Anti-condensation valve:	
Paint and finishes:	Polyester powder paint coating, electrostatically sprayed and sublimated in the oven. Resistant to corrosion
Colour:	Matte black RAL 9005. Optional: other colours
Mounting:	Post-Top or Lateral Ø60mm
Tilt range:	From -15° to +15°
Maintenance:	Easy, tool-less opening. Modular concept for easy component replacement: LEDs, drivers, SPD
Recommended mounting height:	4 - 6 m
Driver:	Constant current adjustable and programmable driver. Embedded in the luminaire, pre-wired on a galvanised steel plate
Flow Reduction:	Dimmable driver 0-10V. Programmable on 5 levels. Optional: DALI 2. Includes the characteristics of Wireless, AOC, MTP, DTL
Ready4IOT - Connectivity:	<ul style="list-style-type: none">- Autonomous multiple-level dimming or virtual midnight- Ready4IoT- Dimming by main voltage- Line switch
Surge protection device (SPD):	Type 2, 10kV and 20kA transient surge protector. Series connection with thermofuse disconnecter for a more effective protection at the end of its service life

DRAWING:

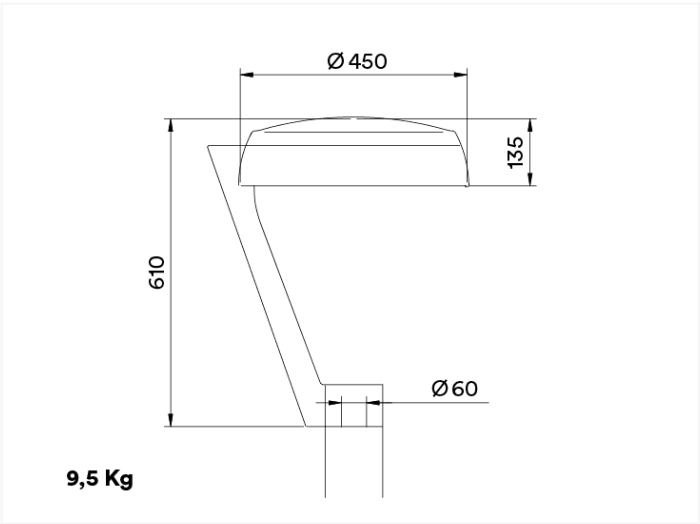

INSTALLATION:



V. 2023-11-06 | The constant improvement and evolution of our products may result in some modifications of the technical specifications and characteristics of the products without prior notice.

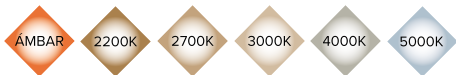

TECHNICAL DATA:

	REF.	N° LEDs	Power W	I Driver mA	Real luminous flux (T) =85°C		Initial luminous flux (T) =25°C	
					Flux lm	Efficacy lm/W	Flux lm	Efficacy lm/W
DECO LIRA	ILD L	16	20	375	2842	142	3240	162
		16	30	563	4242	141	4836	161
		16	40	750	5642	141	6432	161
		32	40	375	5680	142	6475	162
		32	60	563	8460	141	9644	161
		32	80	750	11280	141	12859	161
		48	80	500	11360	142	12950	162

Luminous flux and efficiency at 4000°K and CRI>70.
 Luminous flux tolerance < +/-3%.
 Values may be subject to changes due to LED binning.

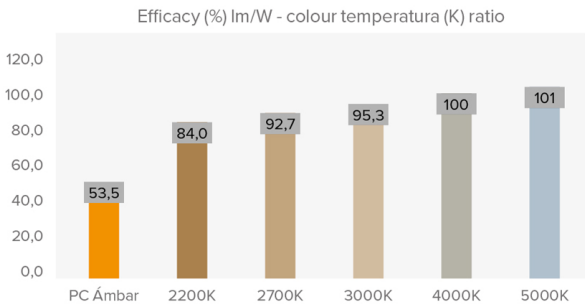

PHOTOMETRY:

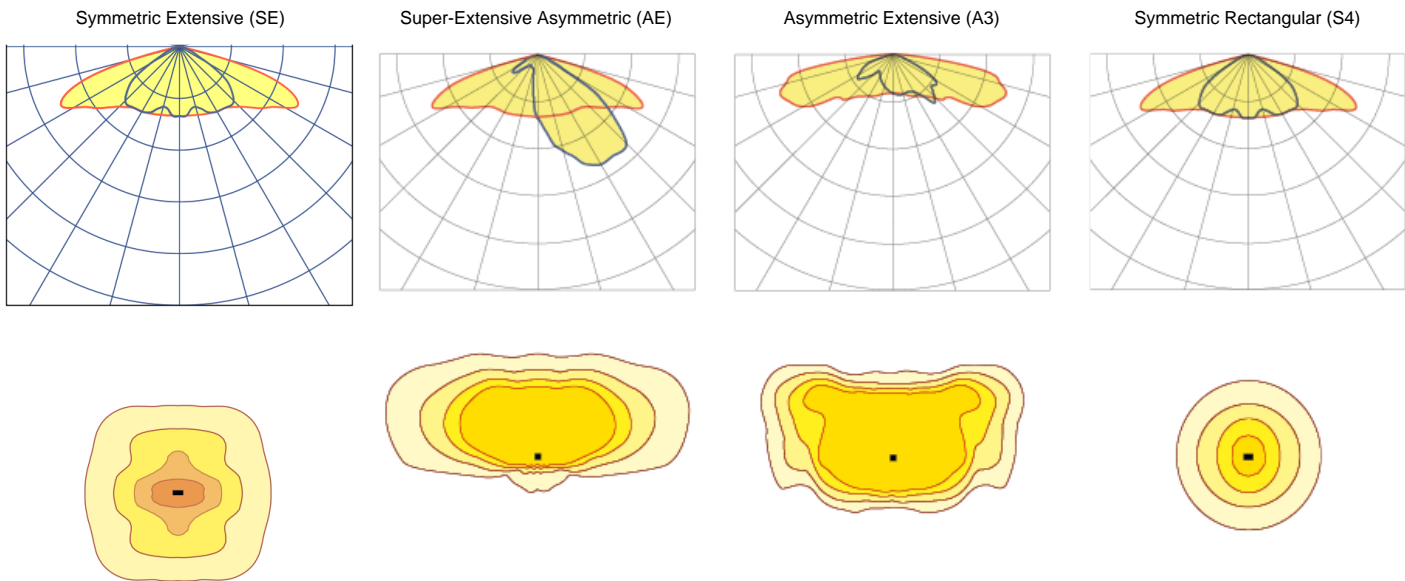

*Show 4 recommended lighting distributions. Refer to the 18 typologies.

V. 2023-11-06 | The constant improvement and evolution of our products may result in some modifications of the technical specifications and characteristics of the products without prior notice.

LEDs MODULE:		
LEDs module:	BENITO-NOVATILU Zhaga standard for 8 and 16 LEDs. Check colour temperature, CRI and light distributions	
Replaceable module:	Yes	
LED:	5050	
Number of LEDs:	16-32	
PCBs format:	1 o 2 Zhaga (Book 15) 2x8	
LED nominal efficacy:	172 lm/W	
Colour temperature:	PC Amber, 2K2, 2K7, 3K, 4K, 5K	
Colour rendering index CRI:	>70 (optional >80)	
Average LED useful time L90B10:	L90B10 >100.000 horas	

OPTIC SPECIFICATIONS:		
Optic system:	PMMA lenses 2x2	
Light distributions:	18 light distribution curves	
Upward light output ratio ULOR:	0%	
Downward light output ratio DLOR:	100%	
Glare index:	Between D5 and D6 (depending on the light distribution)	
Luminous intensity category:	Between G*4 and G*6 (depending on the light distribution)	
Luminous flux CIE n°3:	>95%	
Photobiological safety:	RG0 (exempt of risk)	
Initial luminous flux Tj=25°C (up to):	lm	12859
Initial luminaire efficacy Tj=25°C (up to):	lm/W	162
Real luminous flux Tj=85°C (UNE EN 13032-4) (up to):	lm	11280
Real luminaire efficacy Tj=85°C (UNE EN 13032-4) (up to):	lm/W	142 (Rendimiento = 82.6 % lm/W (Real 85°C) ÷ lm/W (Nominal Led))

ELECTRIC SPECIFICATIONS:		
Nominal maximum power (LEDs):	W	72
Maximum power consumed (luminaire):	W	80
Power range:	W	20 - 120W
Maximum current of LED:	mA	<400 (<50% I _{max})
Power supply protection classes IEC:	Class I and II	
Surge protection device (SPD):	Type 2, 10kV and 20kA transient surge protector. Series connection with thermofuse disconnecter for a more effective protection at the end of its service life	
Common and differential mode protection (SPD) Udc:	kV	10 y NTC opcional
Max current (8/20) (SPD):	kA	20
Thermal phase disconnection (SPD):	Yes	
Input voltage:	Vac	220-240
Input voltage (max rate):	Vac	198-264
Input frequency:	Hz	47-63
Starting current:	A	<65
Duration of the starting voltage peak:	ms	<0,3
Driver efficacy:	>90%	
Power factor 100% consumption:	>0,98	
Power factor 50% consumption:	>0,95	
Total harmonic distortion (THD):	<10	
Power consumption on standby mode:	<0,4	
Energy class:	A++ IPEA>1,15	

OPERATING CONDITIONS:		
Average LED useful time L90B10:	>100.000	
Average driver useful life to Tp <70°C:	100.000	
Average luminaire useful life L90B10 (TM-21):	72.167	
Ambient temperature (Ta):	°C	de -35°C a +50°C
Aerodynamic resistance (CxS):	m2	0,092
Vibration test (15Hz 3 axis):		
Guarantee:	years	5 years (extensible up to 10 years)

PACKAGING DIMENSIONS:		
Net weight	kg	9,5
Gross weight	kg	11
Luminaire dimensions (LxWxH)	mm	450x450x610
Packaging dimensions (LxWxH)	mm	520x520x170 + 665x175x95
Pieces per box		1
Quantity per container 20ft		
Quantity per container 40ft		

CERTIFICATES:	
Security certificates:	EN 60598-1 / EN 60598-2-3 / IEC 62471
EMC certificates:	EN 55015 / EN 61547 / EN 61000-3-2 / EN 61000-3-3 / EN 61347-2-13 / EN 61347-1 / EN 62384
Other certifications:	IEC 62262 / EN 13032-4 / EN62031 / EN 16474 / ISO 9227 / EN 60068-2-11 / ISO 10289 / EN 61643-12

Company Certifications



BENITO

info@benito.com
tel. 93 852 1000