

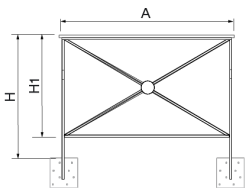

St André Removable
VVBA164M-1



Fence made of steel treated with Ferrus, a protective process that guarantees high resistance to corrosion.



Ref.	A	H	H1
VVBA84	840	1130	930
VVBA164	1640	1130	930



[Maintenance guide](#) | [Project sheet](#) | [Catalogue](#) | [Mounting instructions](#) | [HD image](#)

The Ferrus treatment consists of three layers applied after shot cleaning all impurities: an electrolytic bath, an epoxy coating and a grey RAL 7016 polyester paint coating.
Recommended anchoring: concrete foundation.



V. 2024-02-27 | The constant improvement and evolution of our products may result in some modifications of the technical specifications and characteristics of the products without prior notice.