

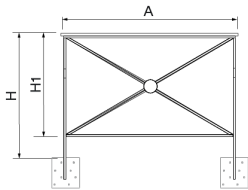

Fence made of steel treated with Ferrus, a protective process that guarantees high resistance to corrosion.



Ref.	A	H	H1
VVBA84	840	1130	200
VVBA164	1640	1130	200



[Maintenance guide](#) | [Catalogue](#) | [HD image](#)

The Ferrus treatment consists of three layers applied after shot cleaning all impurities: an electrolytic bath, an epoxy coating and a grey RAL 7016 polyester paint coating.

Recommended anchoring: concrete foundation.

VVBA84M/1 - VVBA164M/1

