



Project

PROJ-112-2023

Surface: 70 m²

Email: info@benito.com

Telephone: +34 93 852 1000

BENITO
-Playground Equipment

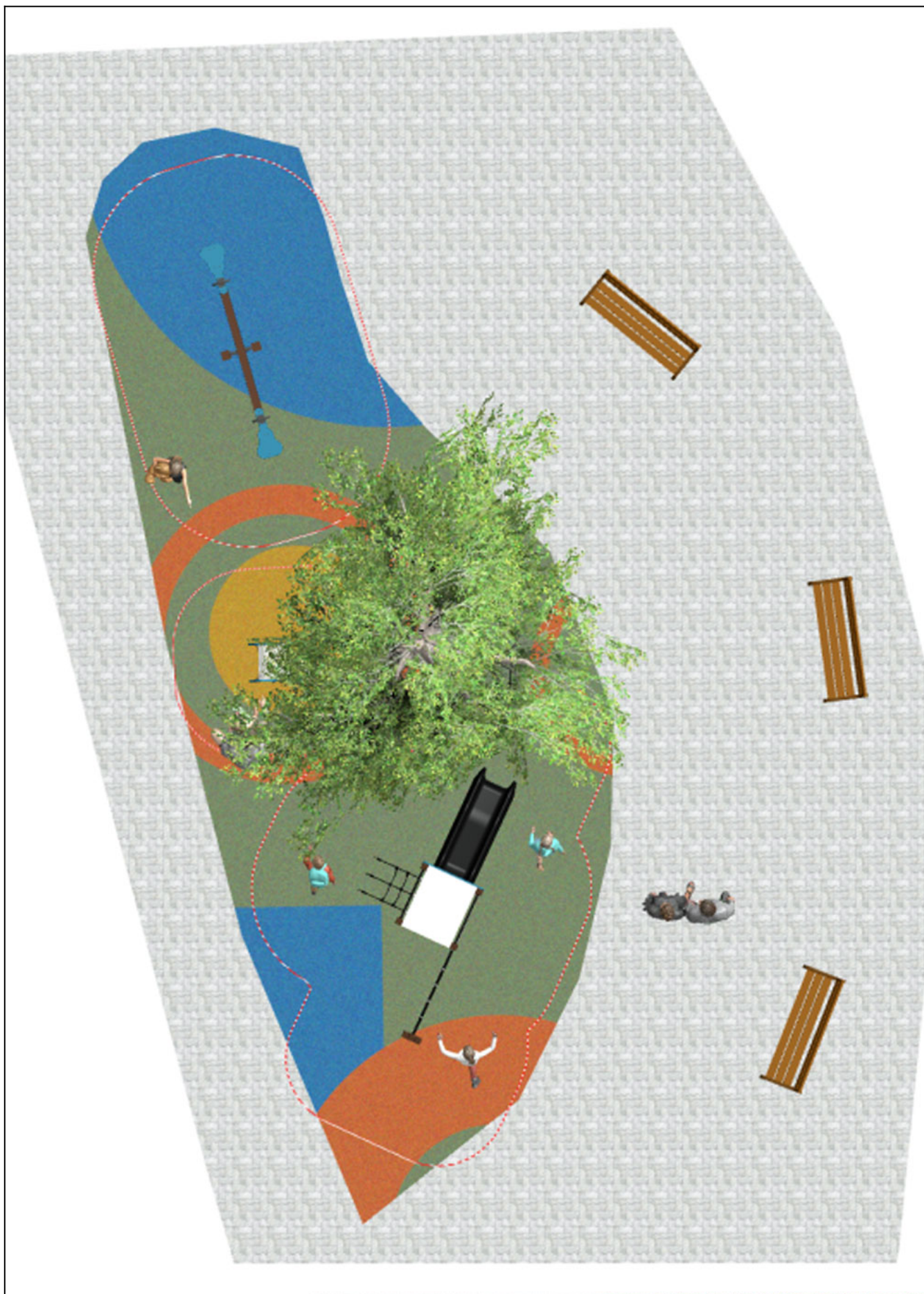



BENITO
-Playground Equipment



BENITO
-Playground Equipment

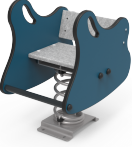

Product	Description
<p>JREB03</p> 	<p>Reb 3 The REB line is designed with ecodesign and open playability criteria in mind. Games made from ReBnew plastic profiles, 100% recycled and recyclable, recovered from the selective collection packaging fraction. Considering that plastic waste takes between 100 and 1,000 years to degrade, this creative reuse promotes circular economy. Multigame structure composed of a platform with different access for climbing and descending (climbing net and inclined climbing ramp), polyethylene slide and roof.</p> <p>Data Sheet Certificate Maintenance recommendations for REBNEW</p>
<p>JREBM02</p> 	<p>Lito The REB line is designed with ecodesign and open playability criteria in mind. Games made from ReBnew plastic profiles, 100% recycled and recyclable, recovered from the selective collection packaging fraction. Considering that plastic waste takes between 100 and 1,000 years to degrade, this creative reuse promotes circular economy. Simple spring swing: game composed of a spring and an abstract design structure.</p> <p>Data Sheet Certificate Maintenance recommendations for REBNEW</p>
<p>JREBM04</p> 	<p>Lar The REB line is designed with ecodesign and open playability criteria in mind. Games made from ReBnew plastic profiles, 100% recycled and recyclable, recovered from the selective collection packaging fraction. Considering that plastic waste takes between 100 and 1,000 years to degrade, this creative reuse promotes circular economy. Two-seat see-saw composed of stainless steel hardware, handles, and a rotating system.</p> <p>Data Sheet JREBM04 Certificate Maintenance recommendations for REBNEW</p>
<p>UM301</p> 	<p>Citizen Exclusive CITIZEN design Bench , total dimensions (length x height x depth) 1800x820x650 mm, manufactured with ductile iron legs (treated with the Ferrus process, the triple-layer protector for iron, which guarantees optimal corrosion resistance). Epoxy primer finish and Marson-colored polyester powder paint. Five tropical wood planks (treated with a triple-layer Lignus coating, a fungicidal, insecticidal and water-repellent protector) in a natural finish. Stainless steel hardware. Recommended anchoring: four M10 expansion bolts depending on the surface and project. Optional items not included: Customizable marking with 74x35 mm aluminum plate or milled board.</p> <p>Data Sheet UM301 Data Sheet Certificate TMA/851/2021</p>