



## Project

PROJ-112-2023

Surface: 70 m<sup>2</sup>

Email: [info@benito.com](mailto:info@benito.com)

Telephone: +34 93 852 1000

**BENITO**  
-Playground Equipment

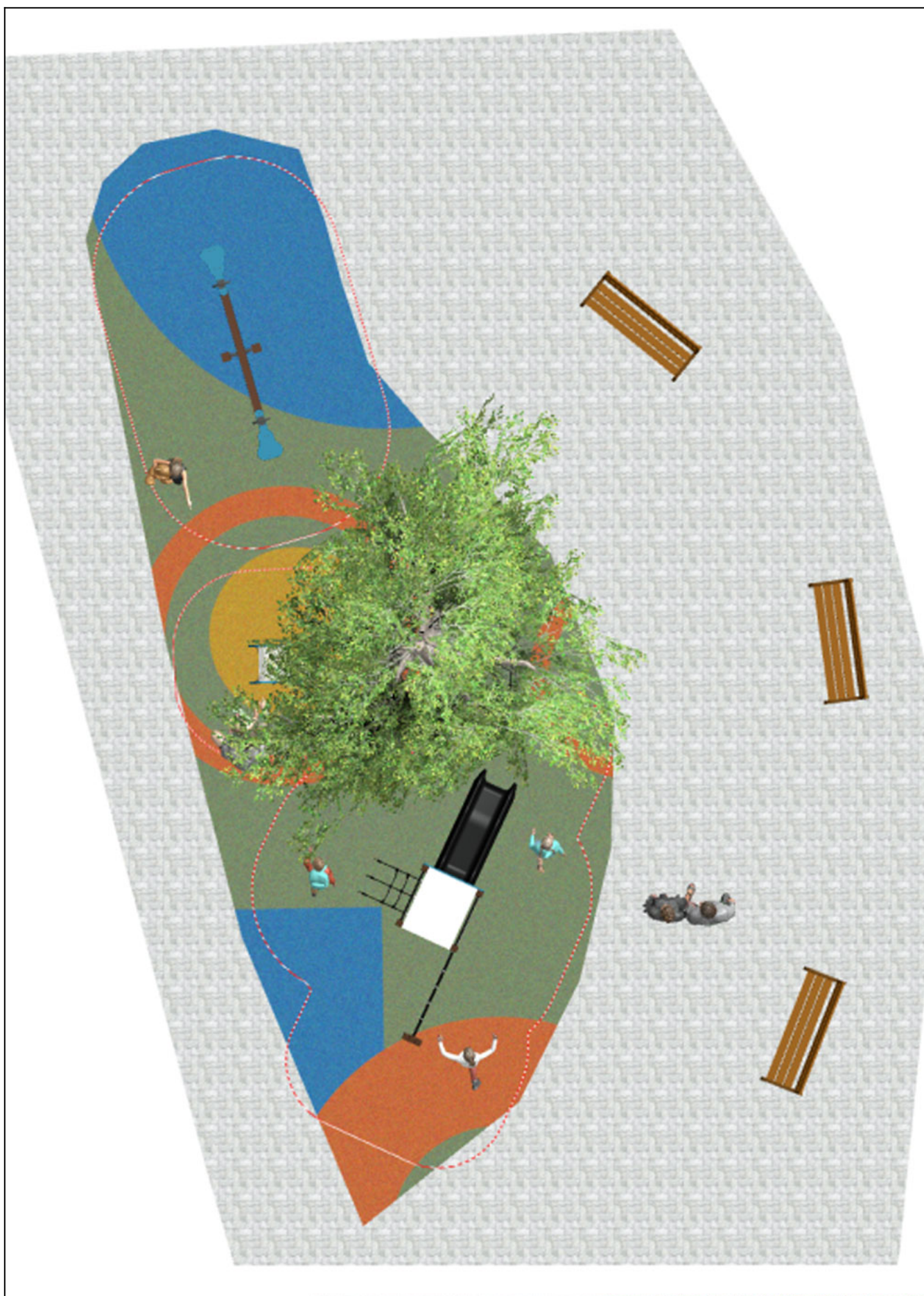



**BENITO**  
-Playground Equipment



**BENITO**  
-Playground Equipment

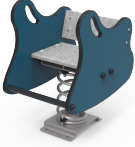

Product	Description
<p>JREB03</p> 	<p><b>Reb 3</b>  The REB line is designed with <b>ecodesign and open playability</b> criteria in mind. Games made from <b>ReBnew</b> plastic profiles, <b>100% recycled and recyclable</b>, recovered from the selective collection packaging fraction. Considering that plastic waste takes between 100 and 1,000 years to degrade, this creative reuse promotes circular economy.  <b>Multigame structure composed of a platform with different access for climbing and descending (climbing net and inclined climbing ramp), polyethylene slide and roof.</b></p> <p><a href="#">Data Sheet</a> <a href="#">Certificate</a> <a href="#">Maintenance recommendations for REBNEW</a></p>
<p>JREBM02</p> 	<p><b>Lito</b>  The REB line is designed with <b>ecodesign and open playability</b> criteria in mind. Games made from <b>ReBnew</b> plastic profiles, <b>100% recycled and recyclable</b>, recovered from the selective collection packaging fraction. Considering that plastic waste takes between 100 and 1,000 years to degrade, this creative reuse promotes circular economy.  <b>Simple spring swing: game composed of a spring and an abstract design structure.</b></p> <p><a href="#">Data Sheet JREBM02</a> <a href="#">Certificate</a> <a href="#">Maintenance recommendations for REBNEW</a></p>
<p>JREBM04</p> 	<p><b>Lar</b>  The REB line is designed with <b>ecodesign and open playability</b> criteria in mind. Games made from <b>ReBnew</b> plastic profiles, <b>100% recycled and recyclable</b>, recovered from the selective collection packaging fraction. Considering that plastic waste takes between 100 and 1,000 years to degrade, this creative reuse promotes circular economy.  <b>Two-seat see-saw composed of stainless steel hardware, handles, and a rotating system.</b></p> <p><a href="#">Data Sheet JREBM04</a> <a href="#">Certificate</a> <a href="#">Maintenance recommendations for REBNEW</a></p>
<p>UM301</p> 	<p><b>Citizen</b>  Exclusive CITIZEN design Bench , total dimensions (length x height x depth) 1800x820x650 mm, manufactured with ductile iron legs (treated with the Ferrus process, the triple-layer protector for iron, which guarantees optimal corrosion resistance). Epoxy primer finish and Marson-colored polyester powder paint. Five tropical wood planks (treated with a triple-layer Lignus coating, a fungicidal, insecticidal and water-repellent protector) in a natural finish. Stainless steel hardware. Recommended anchoring: four M10 expansion bolts depending on the surface and project.  Optional items not included:  Customizable marking with 74x35 mm aluminum plate or milled board.</p> <p><a href="#">Data Sheet UM301</a> <a href="#">Data Sheet</a> <a href="#">Certificate TMA/851/2021</a></p>